

# Semi-Auto Shotgun 12 Gauge



IMPORTANT: When ordering, list part number, part name, gun gauge/caliber and serial number. Please specify grade. Prices F.O.B. point of shipment – subject to change without notice. Prices effective January 1, 2024.

Ref. #	Part #	Description	Ref. #	Part #	Description
1	B111607301	ACTION SPRING	42	U1110630D4	MAGAZINE CAP, MODNA W/SLING EYE
2	B1126523AP	ACTION SPRING TUBE PLUNGER	42	U1110210F1	MAGAZINE CAP, MOOB, W/SLING EYE (U1110210GB WHEN OBSOLETE)
3	U1117474AX	ACTION SPRING RETAINER	42	U1110589BF	MAGAZINE CAP, MOSGB, W/SLING EYE
3	U1110180AX	ACTION SPRING RETAINER (COMPACT)	42	U1110484DP	MAGAZINE CAP, MOSGH, W/SLING EYE
4	BST41273E2	ACTION TUBE RETAINER PIN	42	U11103748F	MAGAZINE CAP, PC GREY, W/SLING EYE
5 *	U1117472AJ	ACTION SPRING TUBE	42	U111035579	MAGAZINE CAP, RT TIMBER, W/SLING EYE (U1110355DT WHEN OBSOLETE)
5 *	U1117683AJ	ACTION SPRING TUBE (COMPACT)	42	U1110692D5	MAGAZINE CAP, RT MAX7 W/SLING EYE
6 *	U1110039AX	BOLT SLIDE UNLOCKING RAMP	42	U1110159R5	MAGAZINE CAP, TT DRT, W/SLING EYE
6 *	U1110505AX	BOLT SLIDE UNLOCKING RAMP (LH)	42	U11104338V	MAGAZINE CAP, TT PRAIRIE, W/SLING EYE (U1110433GC WHEN OBSOLETE)
7	U1110061A2	SLIDE ASSEMBLY, BLACK	42	U111029476	MAGAZINE CAP, TT STRATA, W/SLING EYE
7	U1110504AX	SLIDE ASSEMBLY, BLACK (LH)	42	U1110589D3	MAGAZINE CAP, WOODLAND, W/SLING EYE
7	U1110225W9	SLIDE ASSEMBLY, NICKEL	43	U1117473AA	MAGAZINE FOLLOWER
8	U1110115A2	BOLT ASSEMBLY, BLACK	44	B111699801	MAGAZINE SPRING
8	U1110509AX	BOLT ASSEMBLY, BLACK (LH)	45	B111623201	MAGAZINE SPRING RETAINER
8	U1110226W9	BOLT ASSEMBLY, NICKEL	46	U1117481AA	MAGAZINE THREE-SHOT ADAPTOR
9	N/A	CARRIER	47 *	B1116040AJ	MAGAZINE TUBE 12GA (B1116040NR WHEN OBSOLETE)
10	U111772703	CARRIER DOG	47 *	B1126373NR	STEEL LIGHT MAGAZINE TUBE 12GA (B1126373AJ WHEN OBSOLETE)
11	B111628701	CARRIER DOG BUFFER	48 *	B111620001	HAMMER SPRING
12	B111628502	CARRIER DOG STOP (LOWER)	49 *	B111619802	HAMMER PLUNGER
13	N/A	CARRIER DOG PIN	50 *	B1141055AX	HAMMER SPRING RETAINER PIN
14	U111773601	CARRIER DOG SPRING	51	U1110003AM	OPERATING HANDLE, BLACK
14	B1141247AE	CARRIER DOG SPRING, BUCK/DEER MODELS	51	U1110503CA	OPERATING HANDLE, BLACK (LH)
15	BST26628AE	CARRIER DOG SPRING GUIDE	52 *	U111754002	OPERATING HANDLE PLUNGER
16	B111628401	CARRIER DOG STOP (UPPER)	53 *	U111754502	OPERATING HANDLE PLUNGER PIN
17	U1117925AA	CARRIER LATCH BUFFER	54 *	U1110261AE	OPERATING HANDLE PLUNGER SPRING
18 *	U111751702	CARRIER LATCH PIN	55	B1126524FN	GAS PISTON ASSEMBLY
19 *	U111772501	CARRIER LATCH PIN CLIP (COTTER)	56 *	B1141002AJ	EJECTOR
20 *	U111751801	CARRIER LATCH SPRING	57 *	B1141004AE	EJECTOR SPRING
21	U111772102	CARRIER PIN	58 *	B1141003AJ	EJECTOR PIN, THREADED
22	B111609611	CARRIER PIN RETAINER CLIP (COTTER)	59 ***	U1110002AX	SAFETY
23 *	U1110052W9	CARTRIDGE STOP/CARRIER LATCH ASSY. 3"	60 ***	B111682302	SAFETY PLUNGER
23 *	U1110529NM	CARTRIDGE STOP/CARRIER LATCH ASSY. 3" (LH)	61 ***	B111621211	SAFETY PLUNGER SPRING
23 *	U1110050W9	CARTRIDGE STOP/CARRIER LATCH ASSY. 3.5"	62 ***	B1181068AJ	SEAR
23 *	U1110502NM	CARTRIDGE STOP/CARRIER LATCH ASSY. 3.5" (LH)	63 ***	B111620411	SEAR SPRING
24 *	U111750501	CARTRIDGE STOP SPRING	64	BST10729AE	FRONT SIGHT, DEFENDER, LPA
25 ***	B111620503	DISCONNECTOR	64	BST17353AA	SIGHT, FRONT, RED, FIBER OPTIC, 3X.05
26	B111620301	DISCONNECTER/TRIGGER SPRING	64	BST7663101	SIGHT, FRONT, RED, FIBER OPTIC, BUCK/DEER, H7/13
27 ***	B111620602	DISCONNECTOR PIN	64	BST7662901	SIGHT, FRONT, RED, FIBER OPTIC, TURKEY, H6/14
28	B111623702	SLING SWIVEL STUD RETAINING WASHER	65	U111755003	SLEEVE BAR ASSEMBLY
29 *	B111616403	EXTRACTOR	65	U1110506AA	SLEEVE BAR ASSEMBLY(LH)
29 *	U1110508AJ	EXTRACTOR, (LH)	66	B111615011	SLEEVE BAR RETURN SPRING
30 *	B111616602	EXTRACTOR PIN	67	B1116029AE	SLIDE BUFFER
31 *	B111614002	EXTRACTOR PLUNGER	68	B111633411	GAS O-RING
32 *	B111616701	EXTRACTOR SPRING	70	BST81089AX	STOCK INSERT FOR RECOIL PAD (WOOD STOCK ONLY)
33	B111616912	FIRING PIN	71 *	U1110007W9	CARRIER LATCH, 3"
34	B111617122	FIRING PIN RETAINER PIN	71 *	U1110006W9	CARRIER LATCH, 3.5"
35	B111617001	FIRING PIN SPRING	72 *	U1110004AT	TRIGGER
36	B111696202	SLING EYELET FOR MAGAZINE CAP, BLACK	73 *	B1141055AX	HAMMER SPRING RETAINER
36	B11169628F	SLING EYELET FOR MAGAZINE CAP, GRAY PC	73 *	B111620902	TRIGGER/SEAR PIN
39	B111628002	CARRIER DOG PIN	74	U1110025AA	TRIGGER GUARD, BLACK
40 *	B1116129AJ	LINK	75	B111603401	TRIGGER GUARD BUFFER
41 *	U111754702	LINK PIN	76	B111621702	TRIGGER GUARD PIN BUSHING
42	U1110005AP	MAGAZINE CAP, BLACK, MATTE	78	B111621801	TRIGGER GUARD PIN RETAINER
42	U1110118AP	MAGAZINE CAP, BLACK, MATTE, W/SLING EYE			
42	U1110673D1	MAGAZINE CAP, FDE, W/SLING EYE			
42	U1110147DU	MAGAZINE CAP, MOBL, W/SLING EYE			
42	U1110092DF	MAGAZINE CAP, MOBUC, W/SLING EYE			

\*Indicates part must be fitted by Winchester Repeating arms Service Department or qualified gunsmith.

\*\*Factory installation only - Return firearm for installation.

+Part may be purchased only by holders of current, valid Federal Firearms License.

NOTE: unless otherwise indicated, part is interchangeable between gauges/calibers.

## Winchester Gun Parts Price List

# Semi-Auto Shotgun 12 Gauge



IMPORTANT: When ordering, list part number, part name, gun gauge/caliber and serial number. Please specify grade. Prices F.O.B. point of shipment – subject to change without notice. Prices effective January 1, 2024.

Ref. #	Part #	Description	Ref. #	Part #	Description
79	B111621303	TRIGGER GUARD PIN, MATTE BLACK	BBL	U11103708F	BARREL, 12, 3", 28" PC GREY
79	B111621603	TRIGGER GUARD PIN, NICKEL	BBL	U111036079	BARREL, 12, 3", 28" RT TIMBER
96	U1110054AA	STOCK, PISTOL GRIP CAP, BLACK	BBL	U1110699WL	BARREL, 12, 3", 28" RT MAX7
97	U1117884AA	STOCK DECAL, "W" FOR PISTOL GRIP	BBL	U1110272R5	BARREL, 12, 3", 28" TT DRT
100	BST82208AA	RECOIL PAD LOP SPACER, 12MM/.47"	BBL	U11104428V	BARREL, 12, 3", 28" TT PRAIRIE
100	BST82207AA	RECOIL PAD LOP SPACER, 7MM/.27"	BBL	U1110099X3	BARREL, 12, 3", 28" WATERFOWL, RT MAX5
101	BST10055AA	RECOIL PAD	BBL	U1110618BF	BARREL, 12, 3", 28" WOODLAND
101	* BST3561101	RECOIL PAD, COMPACT COMPOSITE STOCKS ONLY (GRIND-TO-FIT)	BBL	U1110349AM	BARREL, 12, 3.5", 24" MATTE BLACK
102	BST10138EX	RECOIL PAD SCREW (COMPOSITE STOCK PLUS LOP SPACER) 4.2X38	BBL	U1110456WX	BARREL, 12, 3.5", 24" MOBL
102	BST35777EX	RECOIL PAD SCREW (COMPOSITE STOCK) 4.2X32	BBL	U11102283K	BARREL, 12, 3.5", 24" MOBUC
102	BST80270EX	RECOIL PAD SCREW (COMPACT COMPOSITE STOCK) 4.2X32	BBL	U1110634BH	BARREL, 12, 3.5", 24" MODNA
103	BST41350EX	RECOIL PAD SCREW (WOOD STOCK PLUS LOP SPACER) 4.2X38	BBL	U1110207F1	BARREL, 12, 3.5", 24" MOOB (CANTILEVER TURKEY)
103	BST17091EX	RECOIL PAD SCREWS (WOOD STOCK) 4.2X28	BBL	U11102938N	BARREL, 12, 3.5", 26" FDE
105	BST1641003	REAR SLING STUD	BBL	U11103768F	BARREL, 12, 3.5", 26" GRAY PC
106	U1117664AX	ACTION TUBE WASHER (OVAL)	BBL	U1110077AM	BARREL, 12, 3.5", 26" MATTE BLACK
107	U1110129AP	ACTION TUBE WASHER (ROUND CUPPED)	BBL	U1110494CA	BARREL, 12, 3.5", 26" MATTE BLACK (LH)
108	BST81234EX	STOCK BOLT NUT	BBL	U1110141WX	BARREL, 12, 3.5", 26" MOBL
109	U1117663AJ	FOLDED ACTION SPRING TUBE SPACER (WOOD STOCK ONLY)	BBL	U1110710WX	BARREL, 12, 3.5", 26" MOBL (LH)
110	BST10128AP	RECOIL PAD INSERT (COMPOSITE STOCK ONLY)	BBL	U11102293K	BARREL, 12, 3.5", 26" MOBUC
111	B1181043AA	SPACER FOR LOCATING RECOIL PAD	BBL	U1110633BH	BARREL, 12, 3.5", 26" MODNA
4000	U1110063AA	TRIGGER GUARD ASSEMBLY, BLACK	BBL	U1110056XW	BARREL, 12, 3.5", 26" MOSGB
4000	U1110243AA	TRIGGER GUARD ASSEMBLY, BUCK/DEER	BBL	U1110467BD	BARREL, 12, 3.5", 26" MOSGH
4000	U1110511AA	TRIGGER GUARD SIMI ASSEMBLY, (LH) (WITHOUT CARRIER)	BBL	U1110590BD	BARREL, 12, 3.5", 26" MOSGH (LH)
23A	* U1117501AX	CARTRIDGE STOP	BBL	U1110096X3	BARREL, 12, 3.5", 26" RT MAX5
42A	BST1423002	MAGAZINE CAP RETAINER	BBL	U111035379	BARREL, 12, 3.5", 26" RT TIMBER
6A	* BST10119AX	BOLT SLIDE UNLOCKING RAMP RETAINER PIN	BBL	U1110696WL	BARREL, 12, 3.5", 26" RT MAX7
7A	N/A	BOLT SLIDE	BBL	U1110722WL	BARREL, 12, 3.5", 26" RT MAX7 (LH)
8A	N/A	BOLT	BBL	U11104398V	BARREL, 12, 3.5", 26" TT PRAIRIE
BBL	U11107598N	BARREL, 12, 3", 18.5" DEFENDER, FDE	BBL	U1110625BF	BARREL, 12, 3.5", 26" WOODLAND
BBL	U1110242AM	BARREL, 12, 3", 22" CANT. BUCK, MATTE	BBL	U11102928N	BARREL, 12, 3.5", 28" FDE
BBL	U1110132AM	BARREL, 12, 3", 24" MATTE BLACK	BBL	U11103758F	BARREL, 12, 3.5", 28" GRAY PC
BBL	U1110216F1	BARREL, 12, 3", 24" MOOB (CANTILEVER TURKEY)	BBL	U11105988N	BARREL, 12, 3.5", 28" HYBRID HUNTER, FDE
BBL	U1110344XW	BARREL, 12, 3", 24" MOSGB	BBL	U1110079AM	BARREL, 12, 3.5", 28" MATTE BLACK
BBL	U1110600BD	BARREL, 12, 3", 24" MOSGH	BBL	U1110495CA	BARREL, 12, 3.5", 28" MATTE BLACK (LH)
BBL	U11102918N	BARREL, 12, 3", 26" FDE	BBL	U1110142WX	BARREL, 12, 3.5", 28" MOBL
BBL	U1110058AM	BARREL, 12, 3", 26" MATTE BLACK	BBL	U1110709WX	BARREL, 12, 3.5", 28" MOBL (LH)
BBL	U1110524CA	BARREL, 12, 3", 26" MATTE BLACK (LH)	BBL	U11102303K	BARREL, 12, 3.5", 28" MOBUC
BBL	U1110143WX	BARREL, 12, 3", 26" MOBL	BBL	U1110632BH	BARREL, 12, 3.5", 28" MODNA
BBL	U1110073XW	BARREL, 12, 3", 26" MOSGB	BBL	U1110057XW	BARREL, 12, 3.5", 28" MOSGB
BBL	U1110474BD	BARREL, 12, 3", 26" MOSGH	BBL	U1110466BD	BARREL, 12, 3.5", 28" MOSGH
BBL	U11103718F	BARREL, 12, 3", 26" PC GREY	BBL	U1110591BD	BARREL, 12, 3.5", 28" MOSGH (LH)
BBL	U111036179	BARREL, 12, 3", 26" RT TIMBER	BBL	U1110097X3	BARREL, 12, 3.5", 28" RT MAX5
BBL	U1110700WL	BARREL, 12, 3", 26" RT MAX7	BBL	U111035279	BARREL, 12, 3.5", 28" RT TIMBER
BBL	U11104418V	BARREL, 12, 3", 26" TT PRAIRIE	BBL	U1110695WL	BARREL, 12, 3.5", 28" RT MAX7
BBL	U1110098X3	BARREL, 12, 3", 26" WATERFOWL, RT MAX-5	BBL	U1110721WL	BARREL, 12, 3.5", 28" RT MAX7 (LH)
BBL	U1110619BF	BARREL, 12, 3", 26" WOODLAND	BBL	U1110157R5	BARREL, 12, 3.5", 28" TT DRT
BBL	U11102878N	BARREL, 12, 3", 28" FDE	BBL	U11104388V	BARREL, 12, 3.5", 28" TT PRAIRIE
BBL	U1110218AK	BARREL, 12, 3", 28" GLOSS BLACK	BBL	U1110615BF	BARREL, 12, 3.5", 28" WOODLAND
BBL	U1110059AM	BARREL, 12, 3", 28" MATTE BLACK	FRM	U1110030AA	FOREARM, 12, BLACK
BBL	U1110525CA	BARREL, 12, 3", 28" MATTE BLACK (LH)	FRM	U1110240AE	FOREARM, 12, BLACK, (FOR CANTILEVER BUCK BARREL)
BBL	U1110144WX	BARREL, 12, 3", 28" MOBL	FRM	U1110678AA	FOREARM, 12, FDE
BBL	U1110074XW	BARREL, 12, 3", 28" MOSGB	FRM	U1110029EK	FOREARM, 12, FIELD, SATIN OIL, GRD 1
BBL	U1110473BD	BARREL, 12, 3", 28" MOSGH	FRM	U1110151WX	FOREARM, 12, MOBL
			FRM	U11100913K	FOREARM, 12, MOBUC
			FRM	U1110626BH	FOREARM, 12, MODNA
			FRM	U1110214F1	FOREARM, 12, MOOB
			FRM	U1110030XW	FOREARM, 12, MOSGB
			FRM	U1110472BD	FOREARM, 12, MOSGB, DU

\*Indicates part must be fitted by Winchester Repeating arms Service Department or qualified gunsmith.

\*\*Factory installation only - Return firearm for installation.

+Part may be purchased only by holders of current, valid Federal Firearms License.

NOTE: unless otherwise indicated, part is interchangeable between gauges/calibers.

Winchester Gun Parts Price List

# Semi-Auto Shotgun 12 Gauge



IMPORTANT: When ordering, list part number, part name, gun gauge/caliber and serial number. Please specify grade. Prices F.O.B. point of shipment – subject to change without notice. Prices effective January 1, 2024.

Ref. #	Part #	Description
FRM	U1110472BD	FOREARM, 12, MOSGH
FRM	U1110104X3	FOREARM, 12, RT MAX5
FRM	U1110689WL	FOREARM, 12, RT MAX7
FRM	U111035979	FOREARM, 12, RT TIMBER
FRM	U1110163R5	FOREARM, 12, TT DRT
FRM	U11104378V	FOREARM, 12, TT PRAIRIE
FRM	U111029076	FOREARM, 12, TT STRATA
FRM	U1110224EK	FOREARM, 12, UPLAND FIELD/NWTF, SATIN VARNISH, GRD 3
FRM	U1110585BF	FOREARM, 12, WOODLAND
	U111737401	CANTILEVER BUFFER, DEER/TURKEY
	U1110514XH	CARRIER ASSEMBLY, NICHEL (LH)
	U1118067W9	CARRIER ASSEMBLY, NICKEL (RH)
	BST1729101	CHOKE TUBE WRENCH, INV+, 12-20
	BST10208F1	CHOKE TUBE, 12, INV+, BRILEY, XFULL, MOOB
	BST6120101	CHOKE TUBE, 12, INV+, FLUSH, FULL
	BST6120401	CHOKE TUBE, 12, INV+, FLUSH, IMP CYL
	BST6120301	CHOKE TUBE, 12, INV+, FLUSH, MODIFIED
	*** B1126595AX	HAMMER/HAMMER LINK ASSEMBLY
	B111658602	SCOPE BASE RECEIVER INSERT SCREW
	* B111695802	SCOPE BASE RECIEVER INSERT, THREADED PRESS-FIT NUT
	U111736501	SIGHT ASSY, REAR, DEER / TURKEY, FOLDING LEAF
	BST10557AA	SIGHT ASSY, REAR, PICATINNY
STK	U1110067AE	STOCK, 12-20, BLACK
STK	U1110330AE	STOCK, 12-20, BLACK, COMPACT
STK	U1110677AE	STOCK, 12-20, FDE
STK	U1110134EK	STOCK, 12-20, FIELD, COMPACT
STK	U1110026EK	STOCK, 12-20, FIELD, SATIN, GRD 1
STK	U1110758F1	STOCK, 12-20, LONG BEARD, MOOB
STK	U1110149WX	STOCK, 12-20, MOBL
STK	U11100903K	STOCK, 12-20, MOBUC
STK	U1110627BH	STOCK, 12-20, MODNA
STK	U1110212F1	STOCK, 12-20, MOOB
STK	U1110066XW	STOCK, 12-20, MOSGB
STK	U1110342XW	STOCK, 12-20, MOSGB
STK	U1110470BD	STOCK, 12-20, MOSGB, DUCKS UNLIMITED
STK	U1110470BD	STOCK, 12-20, MOSGH
STK	U1110603BD	STOCK, 12-20, MOSGH, COMPACT
STK	U1110103X3	STOCK, 12-20, RT MAX5
STK	U1110691WL	STOCK, 12-20, RT MAX7
STK	U111035779	STOCK, 12-20, RT TIMBER
STK	U1110161R5	STOCK, 12-20, TT DRT
STK	U11104358V	STOCK, 12-20, TT PRAIRIE
STK	U111028576	STOCK, 12-20, TT STRATA
STK	U1110221EK	STOCK, 12-20, UPLAND FIELD/NWTF, SATIN, GRD 2/3
STK	U1110586BF	STOCK, 12-20, WOODLAND
STK	U1110762BF	STOCK, 12-20, WOODLAND, EXTREME DEFENDER

\*Indicates part must be fitted by Winchester Repeating arms Service Department or qualified gunsmith.  
 \*\*Factory installation only - Return firearm for installation.  
 +Part may be purchased only by holders of current, valid Federal Firearms License.  
 NOTE: unless otherwise indicated, part is interchangeable between gauges/calibers.



# Semi-Auto Shotgun 12 Gauge



NOTE: WHEN ORDERING PARTS, USE THE PART NUMBER AND NOT THE SCHEMATIC REFERENCE NUMBER.



## SX4 - SHOTGUNS SEMI-AUTO

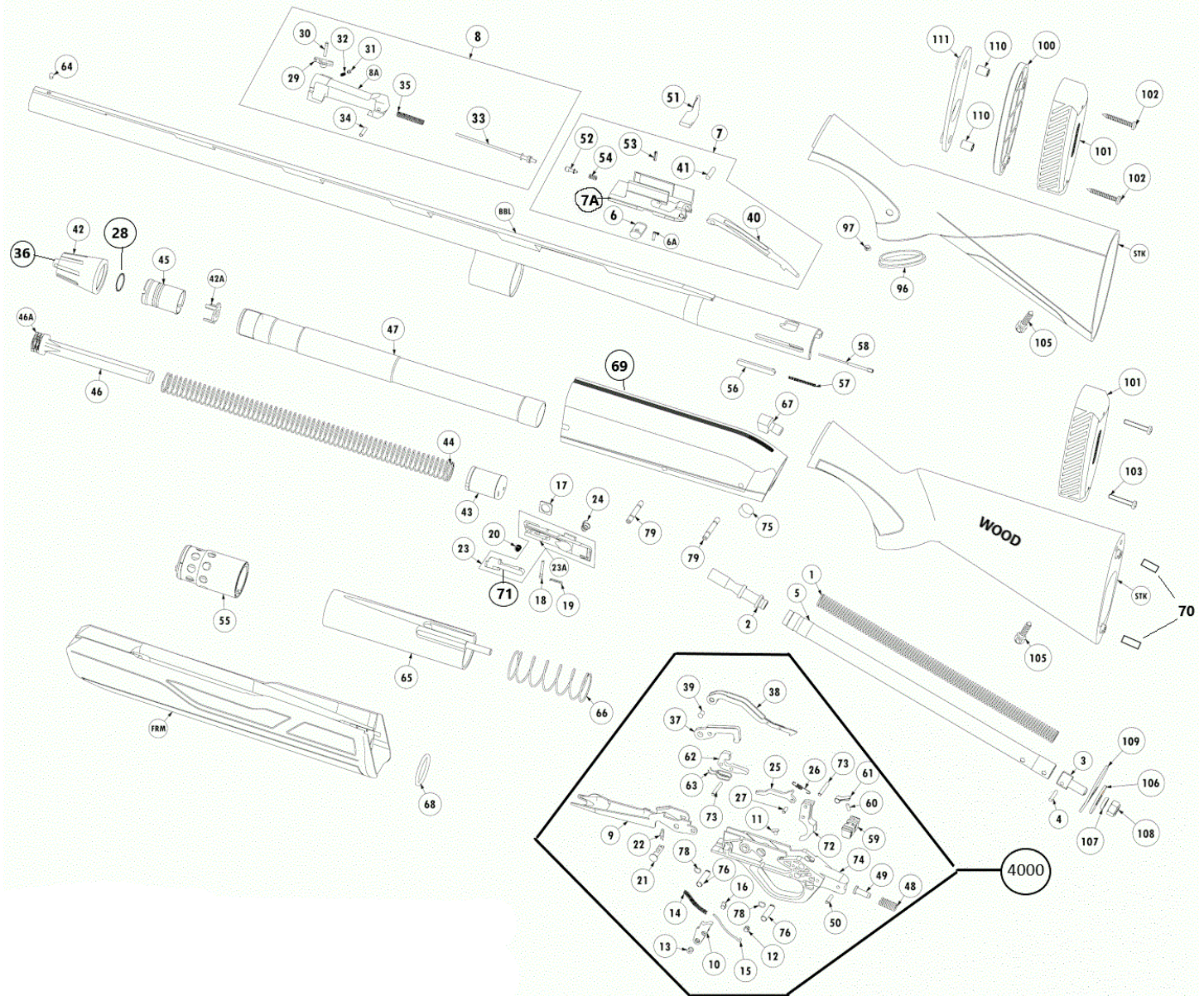

Schematic is provided for parts identification only and should not be used as a guide to assemble guns.  
CAUTION: Winchester parts are not recommended for use in other guns though models may be similar.  
Inadequately fitted parts may be dangerous.

Winchester Gun Parts Price List